

# Southwest Washington Chapter of ICC

This construction detail is accepted as an alternate design.  
and is accepted in the following regional jurisdictions

Clark County, Cowlitz County, Skamania County, City of Camas, City of Centralia, City of Kalama  
City of Longview, City of Ridgefield, City of Vancouver, City of Washougal, City of Woodland

## ONE (1) STORY 2'-8" ALTERNATE BRACED WALL PANEL DESIGN ON A RAISED FLOOR

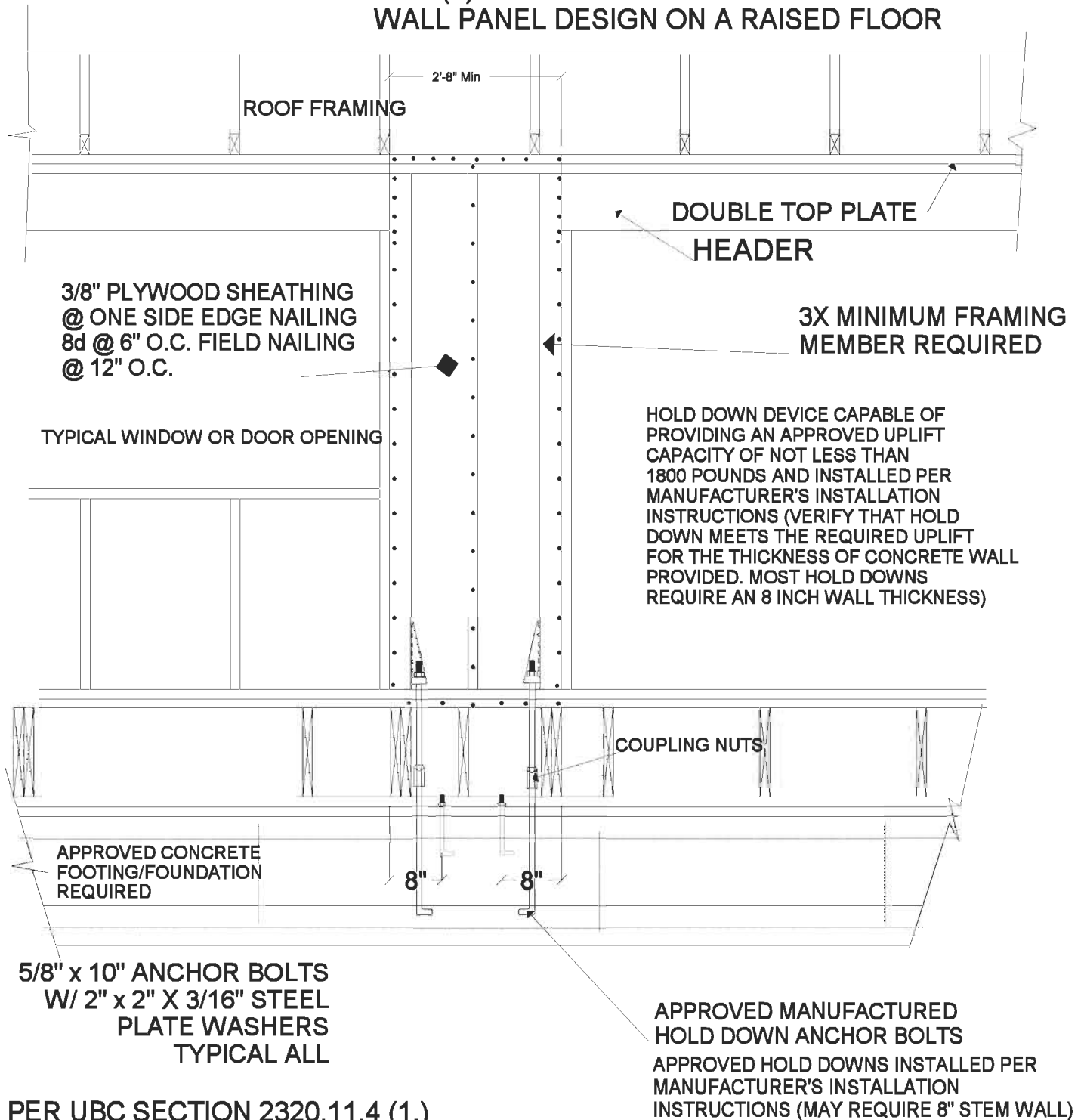

#15 1/1/00

1 STORY 2'-8" RAISED FLOOR ALTERNATE BRACED WALL PANEL DWG BY LGN