

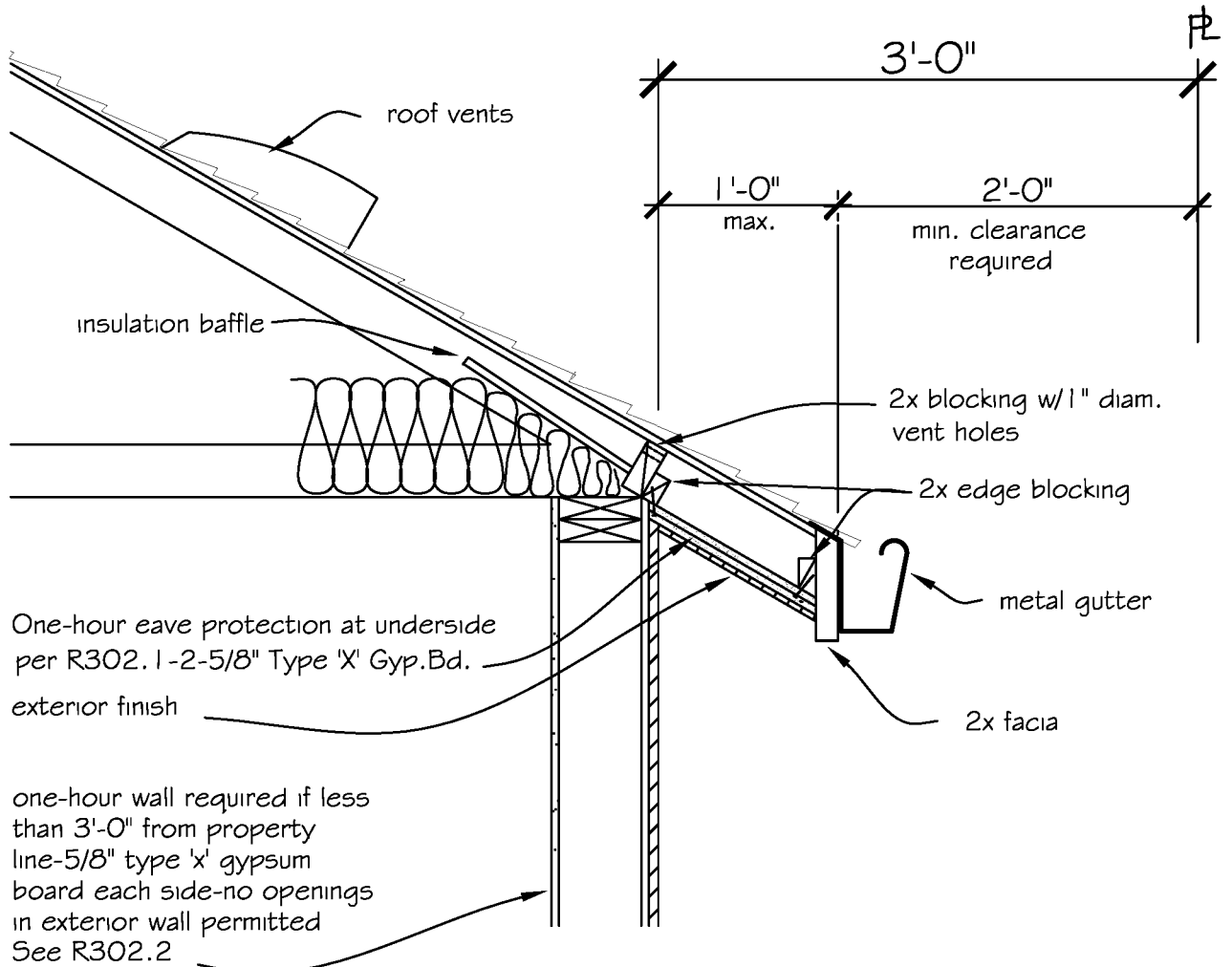

# Southwest Washington Chapter of ICC

This construction detail is illustrative of the minimum standard of construction based upon the 2006 IRC / WAC 51-51



(Table R302.1 not adopted by The State of Washington)

- NOTE :
1. Exhaust, plumbing vents, attic vents- min. 3' from property line at roof penetrations
  2. Penetrations in exterior wall with fire separation distance of less than 3' shall be protected in accordance with R317.3.

## EAVE OVERHANG PROTECTION FOR (R-3) RESIDENTIAL CONSTRUCTION

IRC 2006