

Southwest Washington Chapter of ICC

This construction detail is accepted as meeting the minimum standard of construction as based upon the 2004 IBC / WAC 51-50 requirements and is accepted in the following regional jurisdictions

Clark County, Cowlitz County, Skamania County, City of Camas, City of Centralia, City of Kalama, City of Longview, City of Ridgefield, City of Vancouver, City of Washougal, City of Woodland

1-1/4" - 2" 1-1/2" MIN

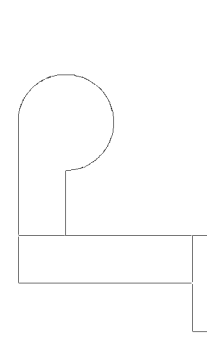
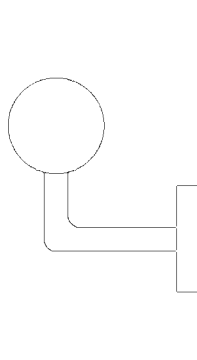
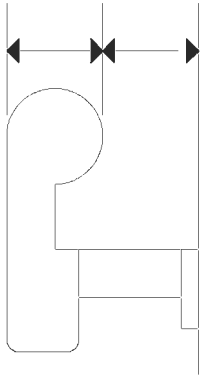

NOTE: OTHER SHAPES MAY BE ACCEPTABLE IF THEY PROVIDE EQUIVALENT GRIPPING SURFACE. SEE UBC SECTION 1003.3.3.6

NOT ACCEPTABLE

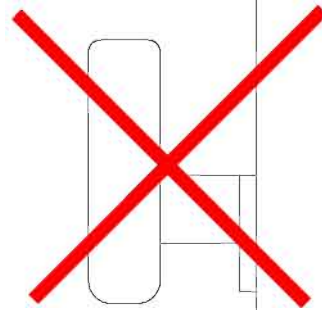
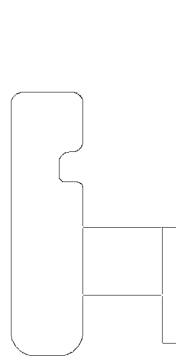
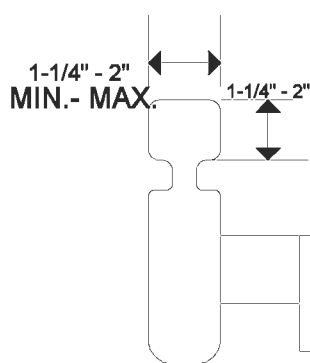

1003.3.3.6 Handrails. Stairways shall have handrails on each side, and every stairway required to be more than 88 inches (2235 mm) in width shall be provided with not less than one intermediate handrail for each 88 inches (2235 mm) of required width. Intermediate handrails shall be spaced approximately equally across the entire width of the stairway.

EXCEPTIONS:

1. Stairways less than 44 inches (1118 mm) in width or stairways serving one individual dwelling unit in Group R, Division 1 or 3 Occupancy or a Group R, Division 3 congregate residence may have one handrail.
2. Private stairways 30 inches (762 mm) or less in height may have a handrail on one side only.
3. Stairways having less than four risers and serving one individual dwelling unit in Group R, Division 1 or 3, or a Group R, Division 3 congregate residence or Group U Occupancies need not have handrails.

The top of handrails and handrail extensions shall not be placed less than 34 inches (864 mm) nor more than 38 inches (965 mm) above landings and the nosing of treads. Handrails shall be continuous the full length of the stairs and, except for private stairways, at least one handrail shall extend in the direction of the stair run not less than 12 inches (305 mm) beyond the top riser nor less than 12 inches (305 mm) beyond the bottom riser. Ends shall be returned or shall have rounded terminations or bends.

EXCEPTIONS:

1. Private stairways do not require handrail extensions.
2. Handrails may have starting or volute newels within the first tread on stairways in Group R, Division 3 Occupancies and within individual dwelling units of Group R, Division 1 Occupancies.

The handgrip portion of handrails shall not be less than 1-1/4 inches (32 mm) nor more than 2 inches (51 mm) in cross sectional dimension or the shape shall provide an equivalent gripping surface. The handgrip portion of handrails shall have a smooth surface with no sharp corners. Handrails projecting from a wall shall have a space of not less than 1-1/2 inches (38 mm) between the wall and the handrail.

#25 5/1/00

HANDRAIL SHAPES