

# Southwest Washington Chapter of ICC

This construction detail is accepted as meeting the minimum standard of construction as based upon the 2004 IBC / WAC 51-50 requirements and is accepted in the following regional jurisdictions

Clark County, Cowlitz County, Skamania County, City of Camas, City of Centralia, City of Kalama, City of Longview, City of Ridgefield, City of Vancouver, City of Washougal, City of Woodland

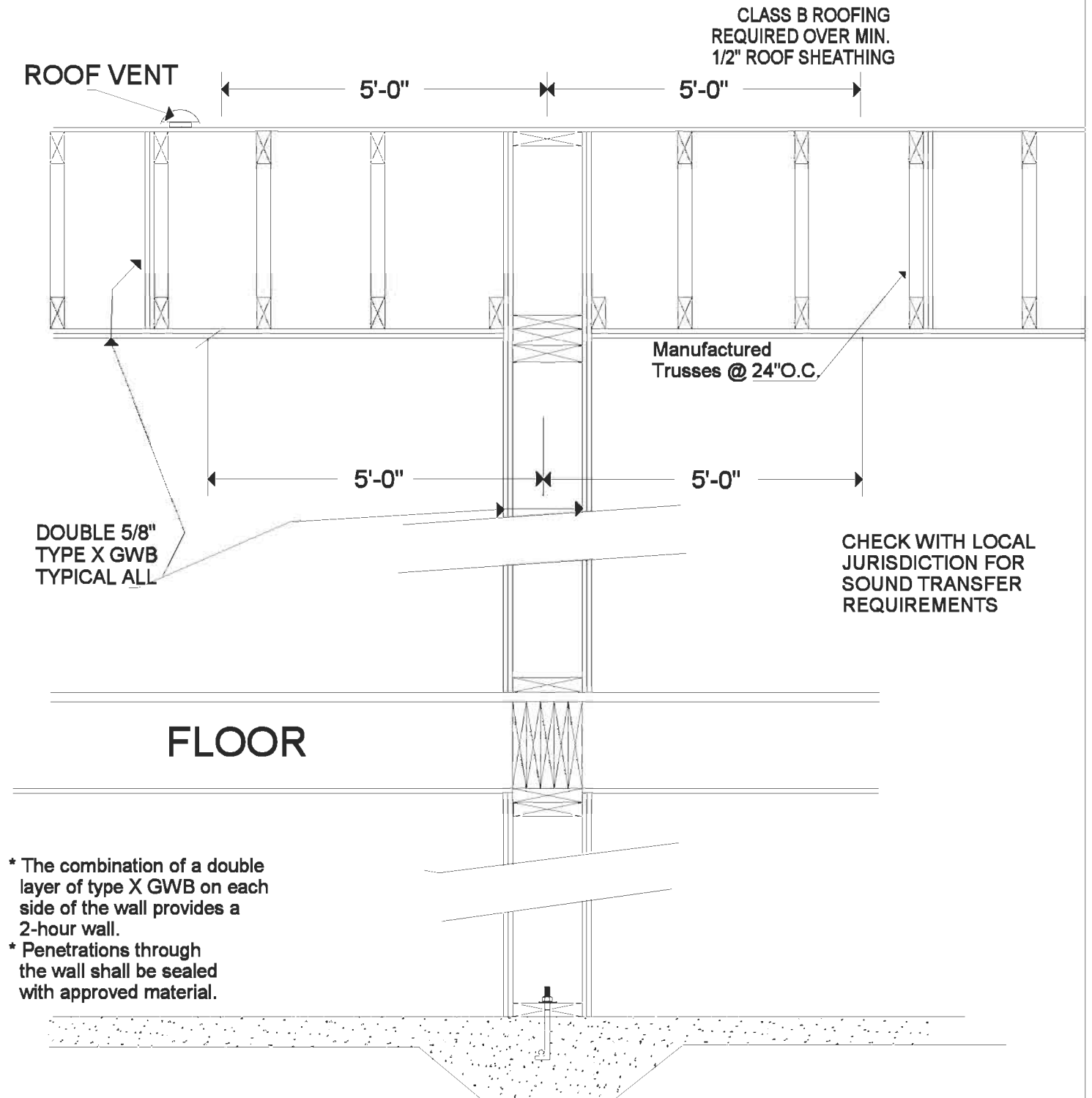

Footing shown for illustration only

#28 6/1/00

TWO HOUR AREA SEPARATION WALL WITHOUT PARAPET

DWG BY LGN