



Southwest Washington Chapter of ICBO

This detail is a clarification of an alternate method of construction.
This alternate method of construction is accepted in the following
Regional Jurisdictions

Clark County, Cowlitz County, Skamania County, City of Camas, City of Centralia, City of Kalama
City of Ridgefield, City of Vancouver, City of Washougal, City of Woodland

CONTACT LOCAL JURISDICTION FOR NAILING
REQUIREMENTS FOR SHEATHING GREATER THAN 3/4"

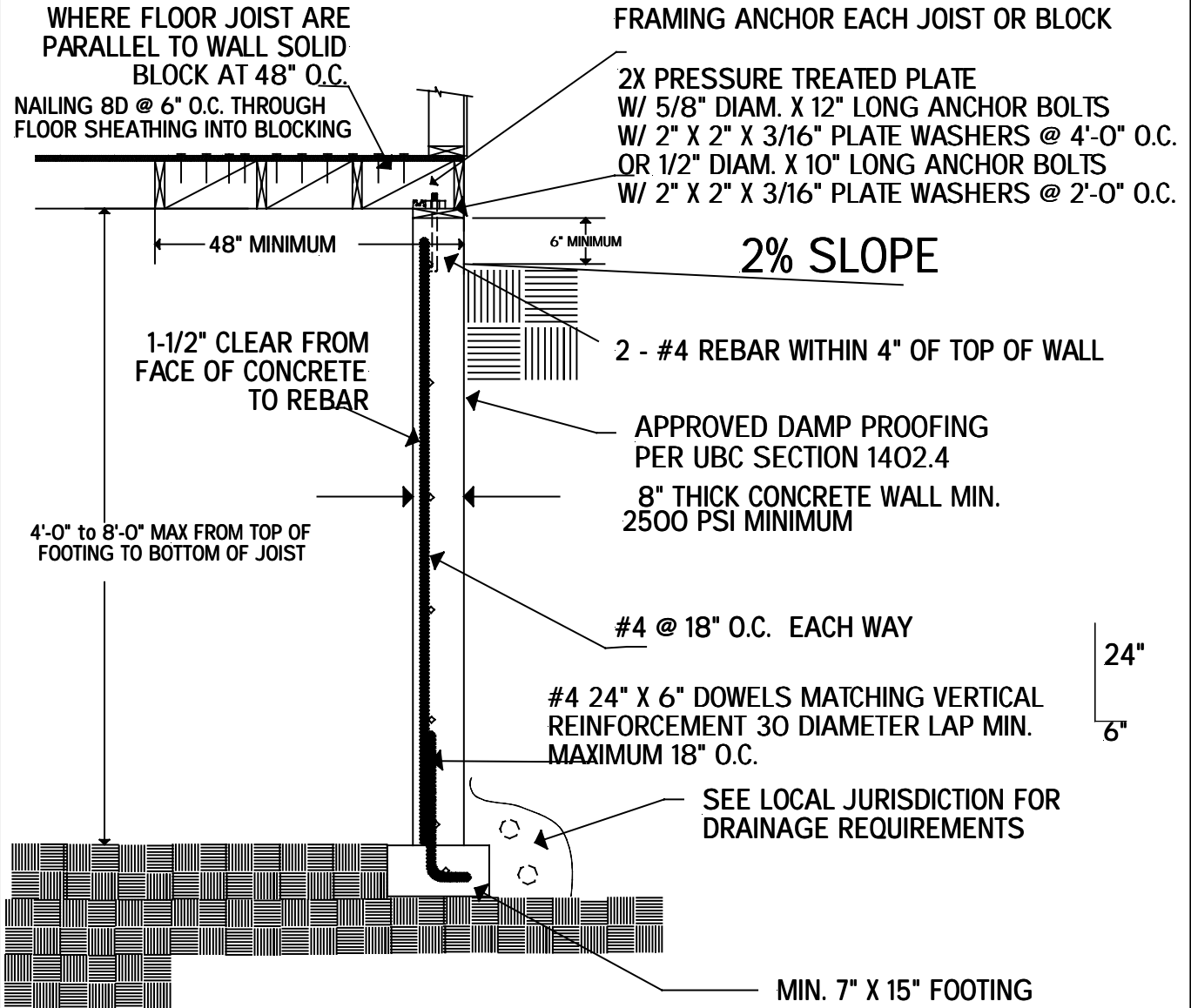

NOTE: FOR CRAWL SPACES WITHOUT SLAB TRENCHED FOOTINGS INTO UNDISTURBED SOIL ARE REQUIRED FOR STEM WALLS OVER 4'-0" IN HEIGHT

NOTE: THIS DRAWING MAY NOT BE ACCEPTABLE IN ALL APPLICATIONS

#4 - 1/1/00

RESIDENTIAL 4'-0" to 8'-0" FOUNDATION WALL WITHOUT A SLAB

DWG BY LGN