

Southwest Washington Chapter of ICC

This construction detail is accepted as meeting the minimum standard of construction as based upon the 2004 IBC / WAC 51-50 requirements and is accepted in the following regional jurisdictions

Clark County, Cowlitz County, Skamania County, City of Camas, City of Centralia, City of Kalama
City of Longview, City of Ridgefield, City of Vancouver, City of Washougal, City of Woodland

1997 UBC SECTION 302.4 EXCEPTION 3.

WHEN THERE IS A WALL AND/OR CEILING DIRECTLY SEPARATING A GARAGE AND LIVING AREA IN FIRE RESISTIVE CONSTRUCTION, SEAL AROUND PENETRATIONS AT CEILINGS AND WALLS INCLUDING FIRE PROTECTION AT DOOR, PIPE, DUCTS AND ELECTRICAL PENETRATIONS

CEILING

WOOD JOIST, TJI'S, OR WOOD TRUSSES UP TO 24" O.C.;
1 LAYERS OF 5/8" TYPE X GYP. BD. APPLIED
PERPENDICULAR TO THE JOIST, ENDS CENTERED
ON JOISTS.

NAIL 6D @ 6" O.C. OR SCREWS @ 24" O.C.

WHERE OCCUPANCY SEPARATIONS ARE HORIZONTAL
STRUCTURAL MEMBERS SUPPORTING THE SEPARATION
SHALL BE PROTECTED BY EQUIVALENT FIRE PROTECTIVE
CONSTRUCTION

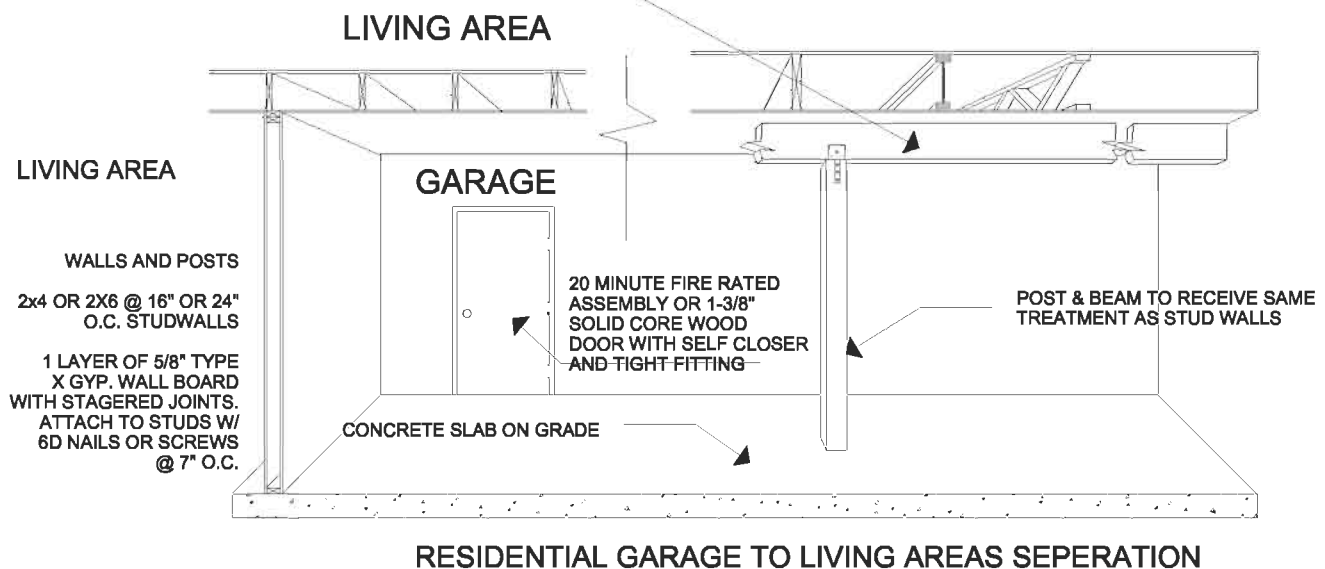

NOTES;

ALL FASTENERS MUST BE GYP. BD. TYPE AND FASTENED TO JOIST OR STUDS
UNLESS OTHERWISE NOTED

ALL SCREWS MUST BE 1-1/4" LONG GYP. BD. TYPE W UNLESS OTHERWISE NOTED.

#45 11/1/01