

Southwest Washington Chapter of ICC

This construction detail is accepted as meeting the minimum standard of construction as based upon the 2004 IBC / WAC 51-50 requirements and is accepted in the following regional jurisdictions

Clark County, Cowlitz County, Skamania County, City of Camas, City of Centralia, City of Kalama, City of Longview, City of Ridgefield, City of Vancouver, City of Washougal, City of Woodland

UBC 1402.1

ALL WEATHER-EXPOSED SURFACES SHALL HAVE A WEATHER RESISTIVE BARRIER TO PROTECT THE INTERIOR WALL COVERING. SUCH BARRIER SHALL BE EQUAL TO THAT PROVIDED FOR IN UBC STANDARD 14-1 FOR KRAFT WATERPROOF BUILDING PAPER OR ASPHALT SATURATED RAG FELT. SUCH FELT OR PAPER SHALL BE APPLIED HORIZONTALLY, WITH THE UPPER LAYER LAPPED OVER THE LOWER LAYER NOT LESS THAN 2 INCHES. WHERE VERTICAL JOINTS OCCURE, FELT OR PAPER SHALL BE LAPPED NOT LESS THAN 6 INCHES.

UBC 1402.2

EXTERIOR OPENINGS EXPOSED TO THE WEATHER SHALL BE FLASHED IN SUCH A MANNER AS TO MAKE THEM WATERPROOF.

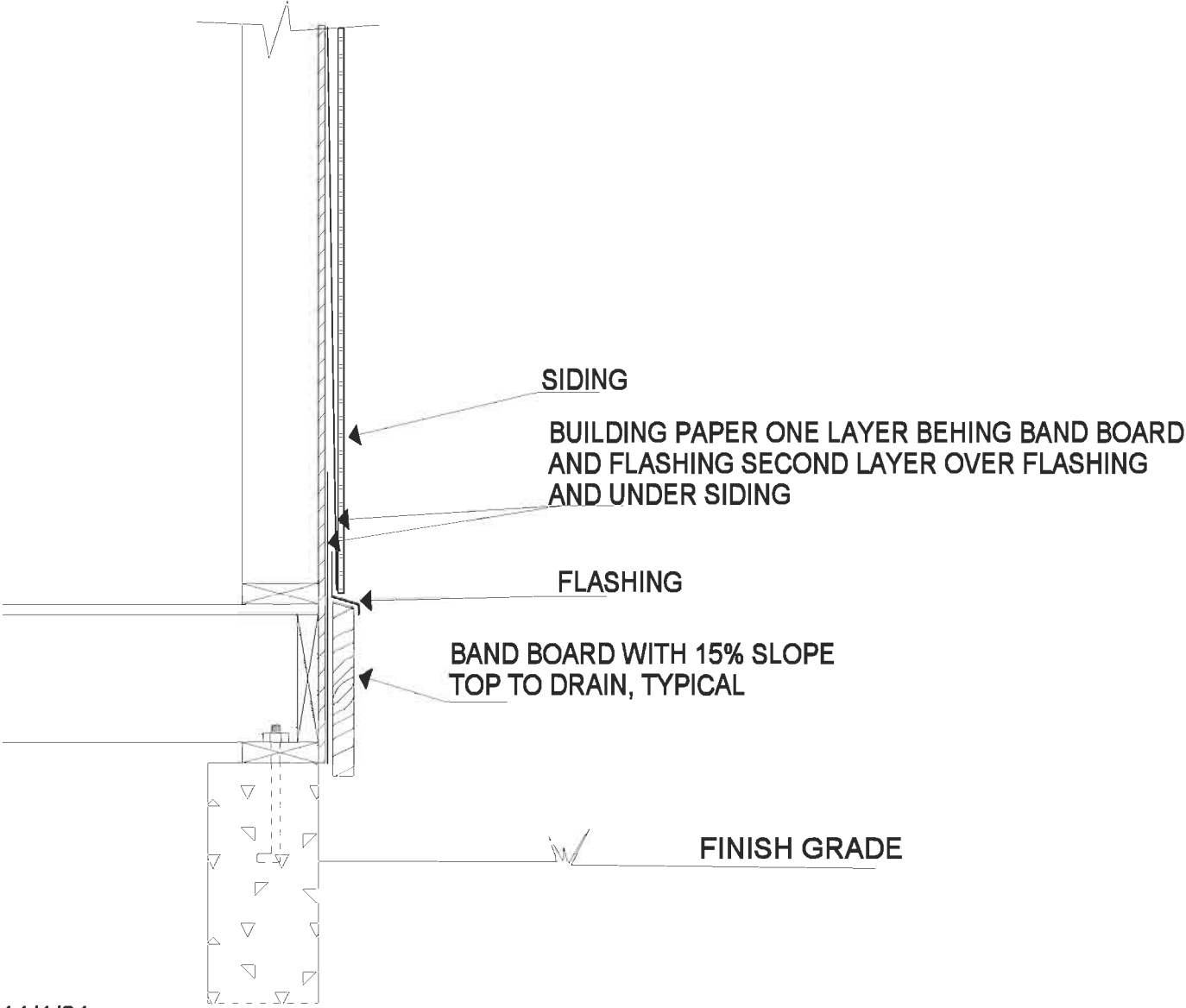

#47 11/1/01

WALL FLASHING CROSS SECTION

DWG BY LGN