

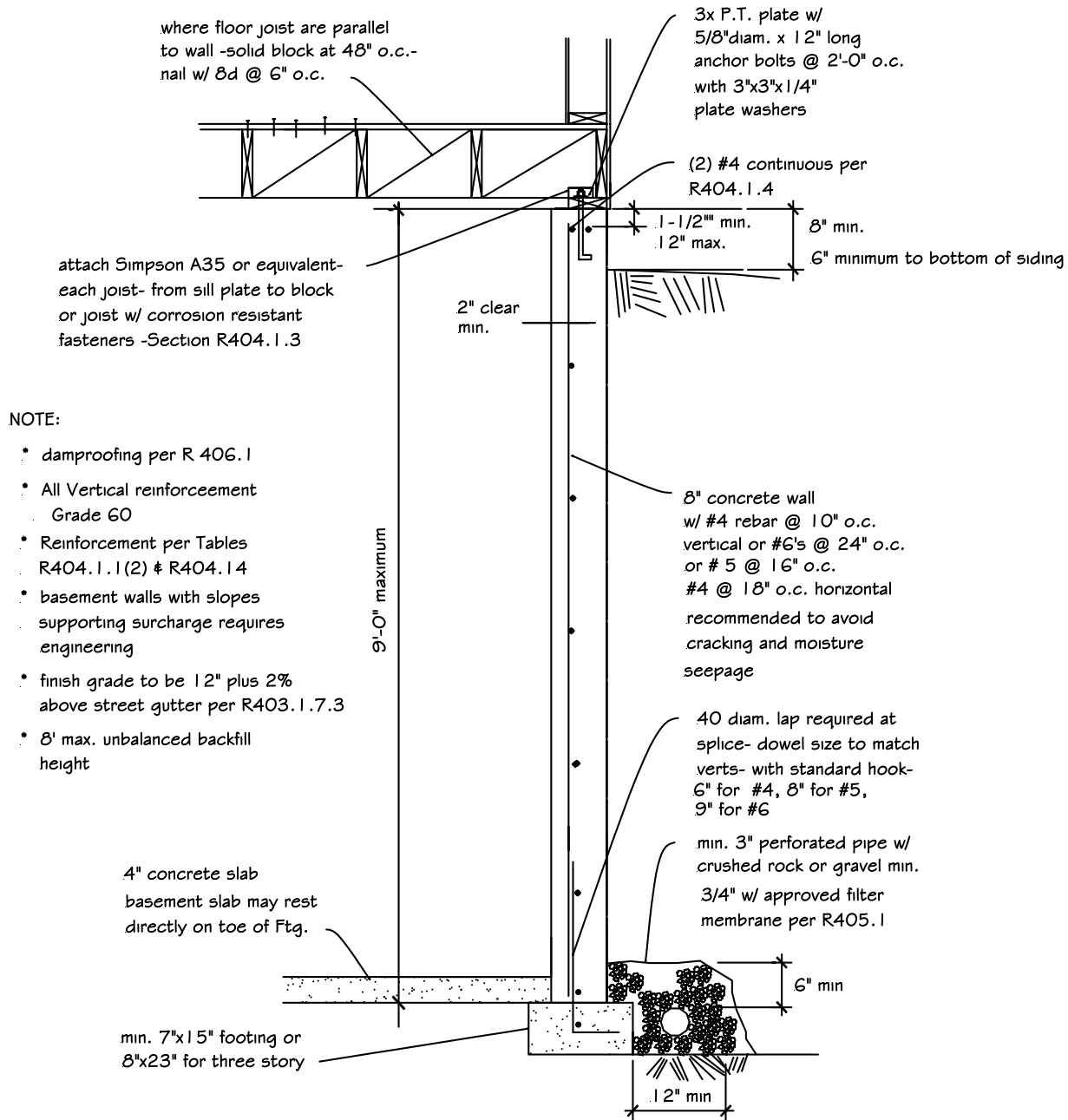

# Southwest Washington Chapter of ICC

This construction detail is accepted as meeting the minimum standard of construction as based upon the 2003 IRC / WAC 51-51 requirements and is accepted in the following regional jurisdictions

**Cities of;** Camas, Centralia, Kalama, Ridgefield, Castle Rock, Vancouver, Washougal, Winlock, Woodland, Longview, Battle Ground,  
**Counties of;** Clark, Cowlitz, Skamania, Lewis



## R404.1.1(2)

R404.1.1(2) 3/04

TYPICAL RESIDENTIAL BASEMENT WALL- 4' TO 8' HIGH

DWG BY LM