



# Southwest Washington Chapter of ICC

This construction detail is accepted as meeting the minimum standard of construction as based upon the 2003 IRC / WAC 51-51 requirements and is accepted in the following regional jurisdictions

**Cities of;** Camas, Centralia, Kalama, Ridgefield, Castle Rock, Vancouver, Washougal, Winlock, Woodland, Longview, Battle Ground,  
**Counties of;** Clark, Cowlitz, Skamania, Lewis

## TYPICAL GARAGE OR STORAGE SHED WALL SECTION accessory to 1 or 2 family dwellings

Check with local Jurisdiction  
for frost depth requirements

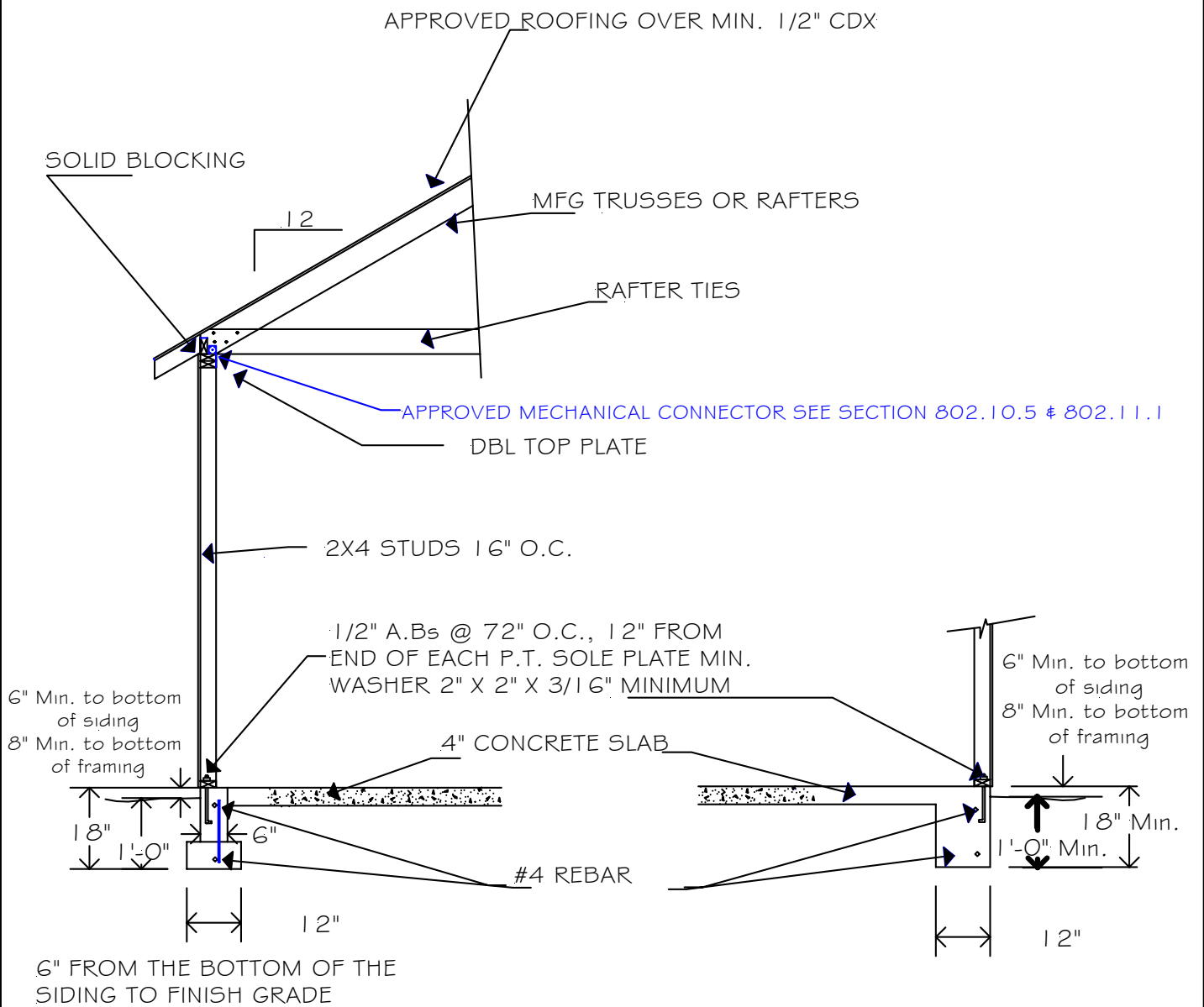

RG01\*1

## TYPICAL CROSS SECTION

DWG BY LGN