

ROOF TYPES

(Rafters with Ridge Beam)

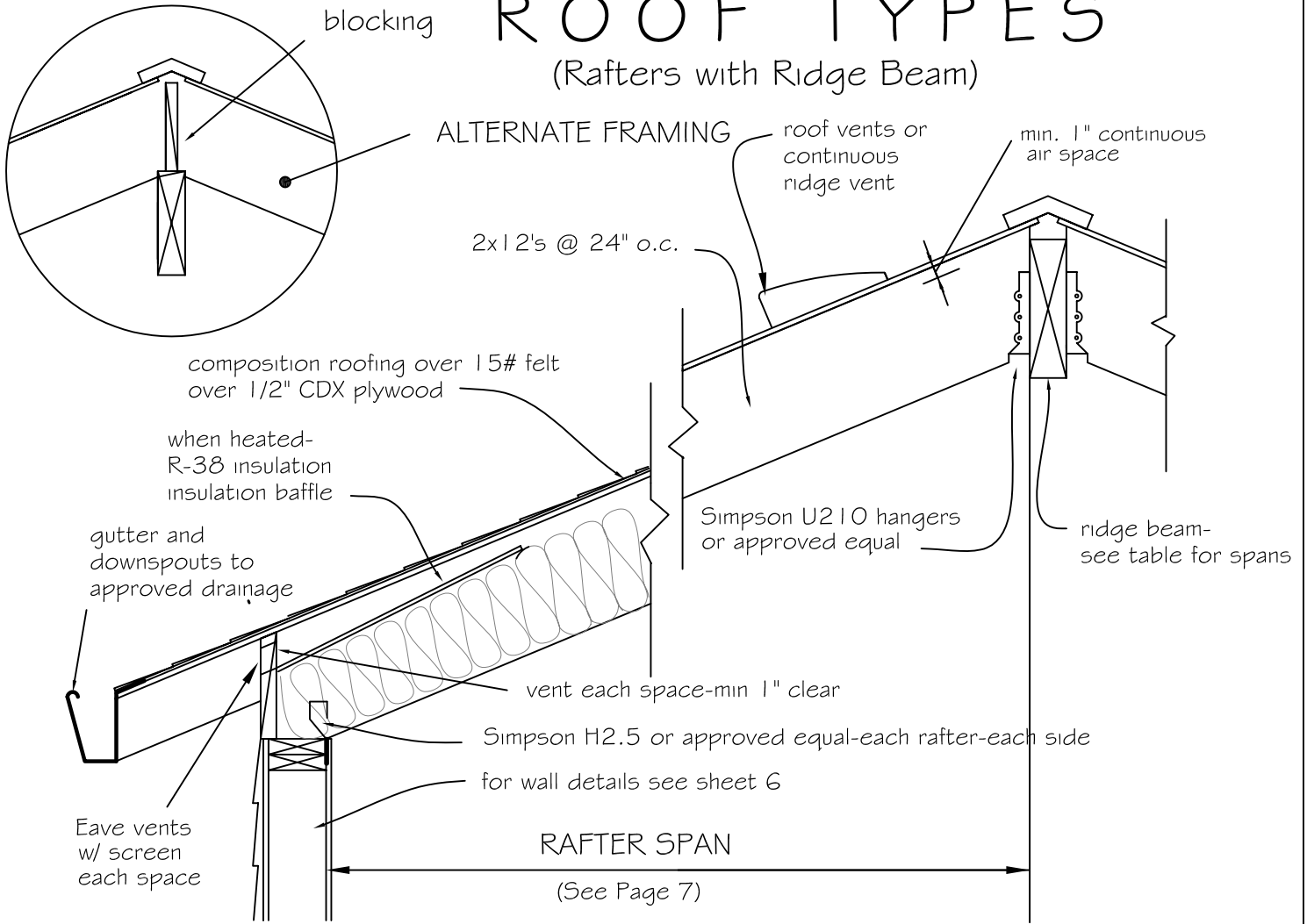

Beam Span

10'-0" 12'-0" 14'-0" 16'-0" 18'-0" 20'-0" 22'-0" 24'-0"

Rafter Span	10'-0"	12'-0"	14'-0"	16'-0"	18'-0"	20'-0"	22'-0"	24'-0"
10'-0"	2-2x12	4x12 #1	6x12 4x14 #1	6x14 #1	5-1/8x13-1/2	5-1/8x13-1/2	5-1/8x15	5-1/8x16-1/2
12'-0"	2-2x12	6x12 4x12 #1	6x12 #1 5-1/8x10-1/2	5-1/8x12	5-1/8x13-1/2	5-1/8x15	5-1/8x16-1/2	5-1/8x18
14'-0"	4x14	4x14 #1 6x12 #1	5-1/8x10-1/2	5-1/8x13-1/2	5-1/8x15	5-1/8x16-1/2	5-1/8x18	5-1/8x19-1/2
16'-0"	4x14	6x12 #1	5-1/8x12 6x14 #1	5-1/8x13-1/2	5-1/8x15	5-1/8x16-1/2	5-1/8x18	5-1/8x19-1/2
18'-0"	4x14 #1	6x14 #1 5-1/8x10-1/2	5-1/8x12	5-1/8x13-1/2	3-1/8x15	5-1/8x16-1/2	5-1/8x18	5-1/8x21

NOTE: 1. 5-1/8" glu-lam beams Fb = 2400 2. 2x, 4x and 6x Douglas Fir #2 Unless otherwise noted
3. Ridge beam to be supported by vertical wall or post to footings

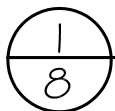

ROOF FRAMING (VAULTED)

scale- 3/4" = 1'-0"