



# Southwest Washington Chapter of ICC

This construction detail is illustrative of the minimum standard of construction based upon the 2018 IRC / WAC 51-51

Visit our web site at: [www.sww-icc.org](http://www.sww-icc.org)

Per the 2018 IRC/WAC R324.3 Photovoltaic panels/modules, shall be listed per UL 1703. Installation, modification, or alteration of solar photovoltaic power systems shall comply with this section and the International Fire Code (IFC) R104.11. Inverters shall comply with UL 1741.

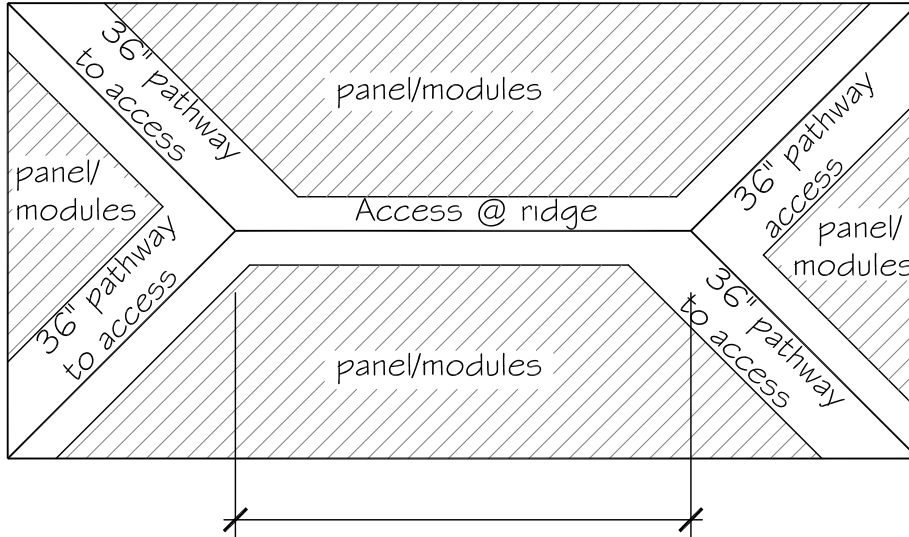

## IRC R324.6.2 Setback at Ridge, typical at hip and gable roofs

Photovoltaic arrays < 33% of the plan view total roof area, requires not less than an 18" clear setback on both sides of a horizontal ridge.

Photovoltaic arrays > 33% of the plan view total roof area, requires not less than a 36" clear setback on both sides of a horizontal ridge.

This allows for fire department smoke ventilation operations and emergency egress.

Exceptions: Detached, nonhabitable structures, per code official determination, 2:12 roof slopes or less.

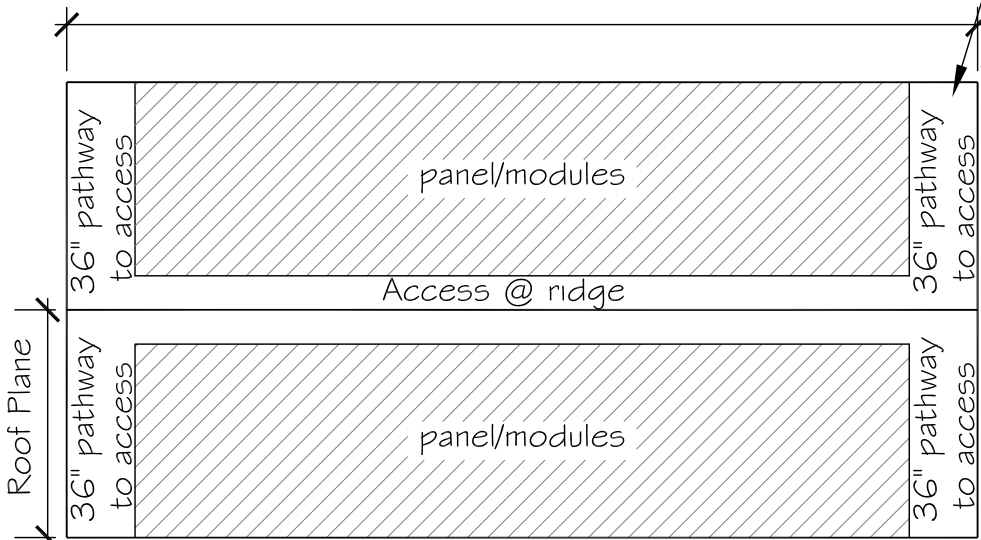

## Notes:

- See R324.4 for structural requirements. The design must take into account the following:
  - Roof loads per R301.4 or R301.6.
  - Wind loads per Table R301.2(2) and Table R301.2(3)
- Rooftop-Mounted Photovoltaic shall be installed per NFPA 70 or meet all of the following:
  - Designed for the local wind speed (check with each jurisdiction) and the manufacturer's specifications.
  - Snow loads 70 psf maximum.
  - The dead loads of modules, supports, mounting, raceways and all other appurtenances shall weigh no more than 4psf.
  - Photovoltaic panels/modules shall be mounted no greater than 18" above the surface of the roof.
  - No point load from supports shall exceed 50 pounds.

## R324.6.1 Pathways.

Not fewer than two pathways, on separate roof planes from lowest roof edge to ridge and not less than 36", shall be provided on all habitable buildings. Not fewer than one pathway shall be provided on the street or driveway side of the roof. Pathways shall be over areas capable of supporting fire fighters accessing the roof. Vent pipes, conduit, or mechanical equipment shall be limited in the pathways.